



*Experience Life Underwater.*

[www.galaxydiveronboard.com](http://www.galaxydiveronboard.com)

*Handbook*





*Experience Life Underwater.*

## *Index*

About Galaxy Diver	2	Deck Plan	10
Awards	3	Salvage and Security Equipment	11
Cabins	4	Itineraries	12
Social Areas	6	Experiences	13
Cuisine	8		
Technical & Safety Features	9		



# About Galaxy Diver

Stunning fully equipped liveaboard yacht that offers a unique experience for diving lovers. You will have the opportunity to explore a wide variety of aquatic life of this marine reserve with our experienced staff and cutting edge equipment. Live a world-class diving experience surrounded by sharks, whales, manta rays, rays, turtles, penguins, iguanas, sea lions and much more, all in one place.



## A rebuilt Atmosphere

Redesigned cabins and social areas combined with privacy for those who enjoy adventure and natural harmony.



## Experience Life Underwater

Eco-conscious services and sustainable offerings



## Once in a lifetime Trip

Experience exceptional scuba diving like no other in the Pacific Ocean only reached on a dive liveaboard



## Best of both Worlds

As a company born and operated by Galapagueños, our commitment to conserve and have the minimum environment impact possible, becomes one of the most important fact.







## *Cabins*

### > **Cozy Cabins:**

A lifetime experience in a renewed cozy environment for those who enjoy friends-family adventures.

### > **Facilities**

- Lower beds
- Endemic local style decoration
- Functional closets
- Air conditioned cabins with personal climate control
- Reading light and charging ports





## Social Areas

### > Dining Room

Broad ocean view windows, to delight the most local and international gastronomy.

### > Lounge

Artistic decoration based on the astonishing array of the Galapagos wildlife, expose by a local artist.

### > Shaded Deck

Ideal for those who love to relax after a perfect day of adventure with splendid oceanic view.

### > Diving Platform

Adapted platform for divers needs.



Dining Room



Lounge



Shaded Deck





# Technical Et Safety Features



## > Dimensions

Length: 29.53m / 96.9 ft  
Beam: 6.6m / 21.7 ft

## > Performance

Cruising Speed 10 knots

## > Electric Power

110V and 220V

## > Operation and Comsuption

Tenders 2 X PUMAR (with 25 hp four stroke outboards)  
Generators 2 ISUZU 60 KW 110/220 V AC, 60 Hz

## > Capacity

Diving itinerary: 14 pax + 2 diving guides  
Naturalist itinerary: 16 pax

*Cuisine*



## Deck Plan

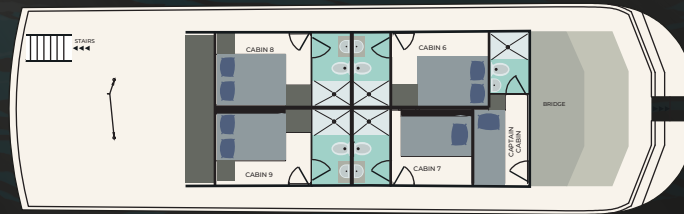

UPPER DECK

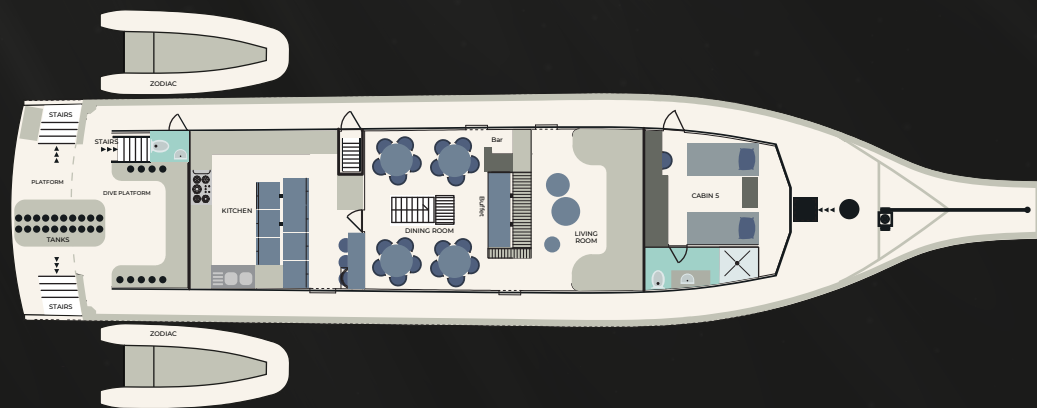

MAIN DECK

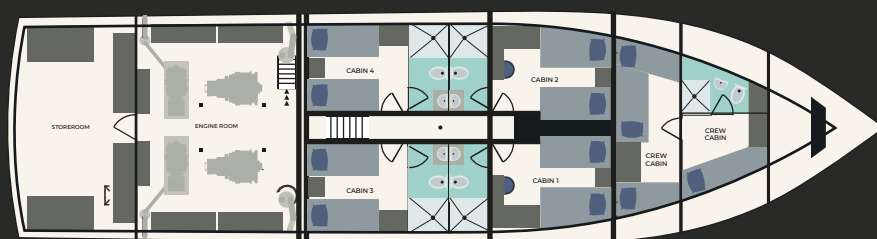

LOWER DECK

## Salvage and Security Equipment



- ✓ Two life rafts (25 persons each)
- ✓ Smoke and fire alarms throughout
- ✓ 406 MHz EPIRB
- ✓ 9 GHz Radar Responder
- ✓ Automatic fire extinguishing system in engine room.
- ✓ Lifejackets for guests + crew
- ✓ Fire extinguishers
- ✓ Lifebuoys 9mm
- ✓ Smoke detectors in rooms and social areas
- ✓ Designated charging stations
- ✓ Emergency Alarm system



